



SoilDoc Kit

Columbia University
Agriculture and Food Security Center

Agriculture and Food
Security Center

EARTH INSTITUTE | COLUMBIA UNIVERSITY

1. What is on stake

A photograph of a cornfield at sunset or sunrise. The ground is parched and cracked, with deep fissures running across the foreground. Several corn plants are visible, some with tassels. The sun is a bright, glowing orb in the upper right sky, casting long shadows. The sky is a deep blue with some light clouds.

250M

There are 250 million malnourished people in rural sub-Saharan Africa. **Lack of information** about soil constraints and lack of access to quality recommendations is a major obstacle to increasing agricultural productivity to address food insecurity.

2. Proposed solution

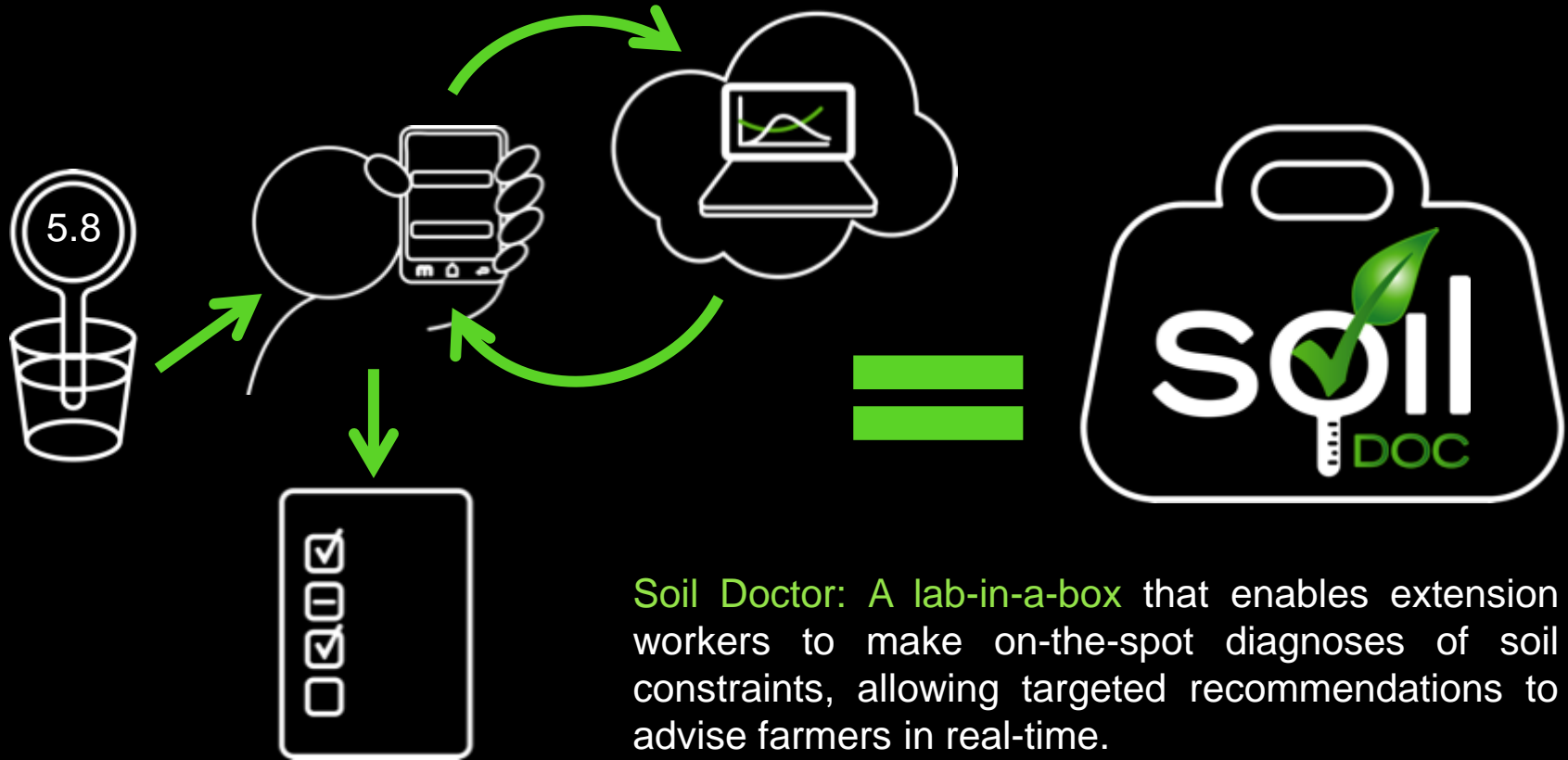

Soil Doctor: A lab-in-a-box that enables extension workers to make on-the-spot diagnoses of soil constraints, allowing targeted recommendations to advise farmers in real-time.

3. Developing a prototype



Experience

Dr. Ray Weil is a Professor at the University of Maryland and Adjunct Senior Research Scientist at Columbia University



Ingenuity

Knowledge and drive to adapt existing technology to solve problems in different contexts



Solutions

Tangible, accessible and smart solutions that work with the environment resources and limitations

4. Refining the idea

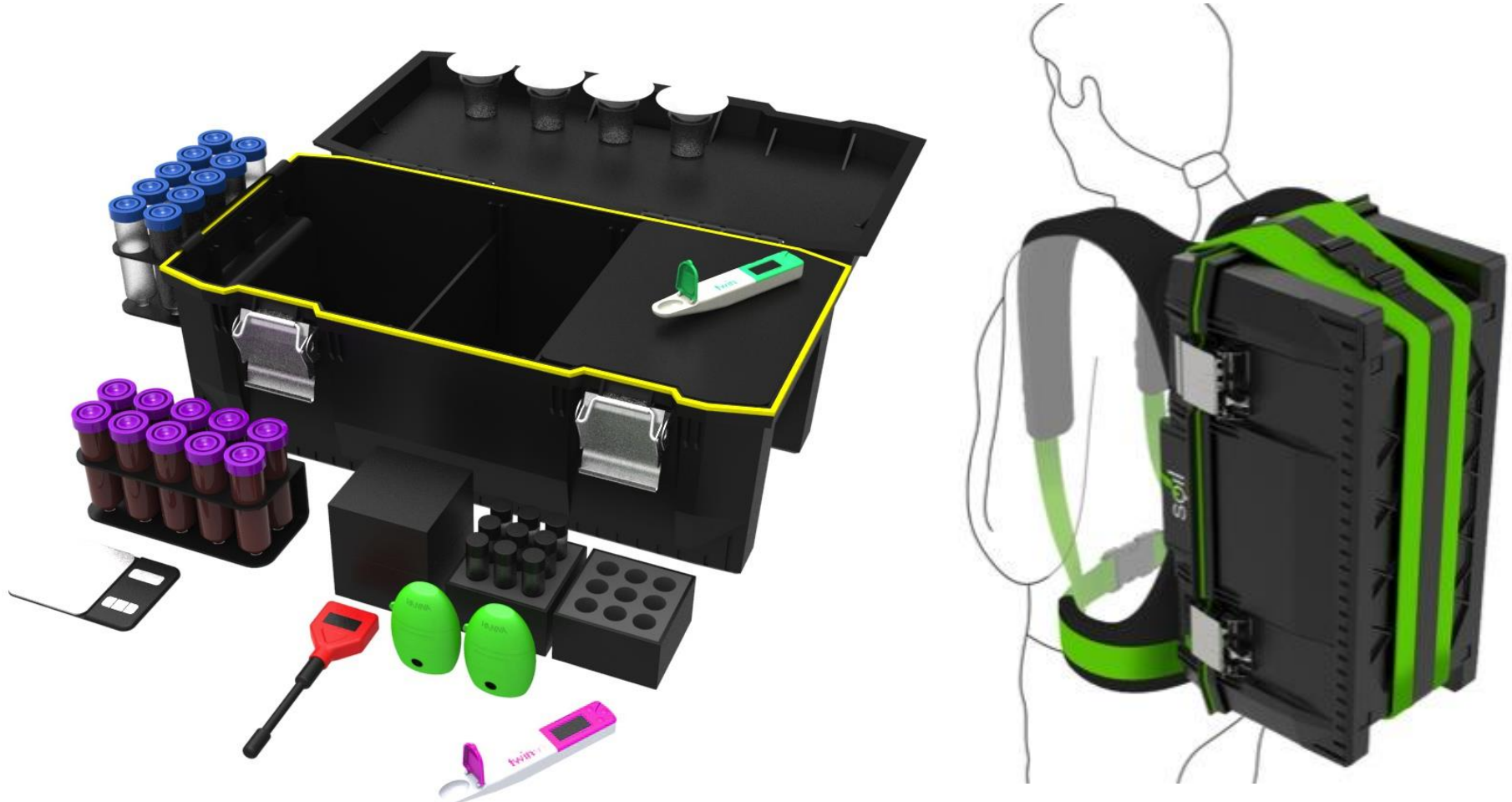

5. Piloting and testing

















Thank you